

# TSM10dp

digitally powered multifunctional Sound System

The TSM10dp is a multifunctional high-power loudspeaker offering extraordinary fidelity and high power with an integral digital amplifier offering 1000 watts total output power and is controlled by a DSP. Several factory set volume settings & presets can be recalled. This enclosure is highly recommendable for full range / hi-mid as well as universal monitor applications. The TSM10dp's low weight and fanless cooling makes it suitable for applications requiring flexibility, performance as well as tonal accuracy and precise imaging.



## PRODUCT SPECIFICATIONS

Speaker Components	10" Neodym / 1"
Description	Multipurpose Sound System
Power	1000 WEIA / 195-250 VAC
Max Line Input	+21dBu
DSP	32bit RISC
Internal Signal Path	32bit fixed-point, 64bit accumulator
	64bit IIR-coefficients
AD/DA	24bit / 48kHz
Latency	1.54ms (analog in to analog out)
Signal/Noise Ratio	115dB
All components comply with industrial temperature range	
SPL max 1m	126dB
Frequency Range	50Hz - 20kHz (Flat-Preset)
Tuning Frequency - Excursion min.	68Hz
X - Overpoint - acoustical	1,5kHz
Connectors	Neutrik XLR in/out
	Neutrik PowerCon in/out
Coverage - horizontal / vertical	90° x 60° - rotatable
Handles	ergonomic handle on top
Rigging - flying points	3 x M10 / 6 x M8
Fittings	35mm pole mount
Weight	16,0kg
Size - height x width x depth	51,5 x 32,4 x 29,5 cm
Order Number	0960 dp

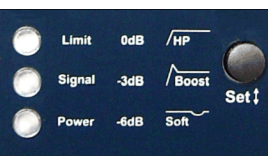
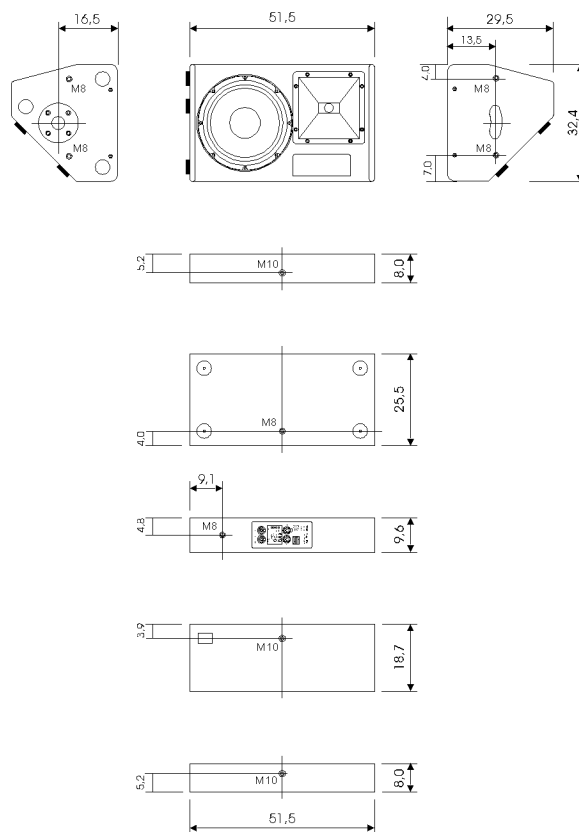

# TSM10dp

digitally powered multifunctional Sound System

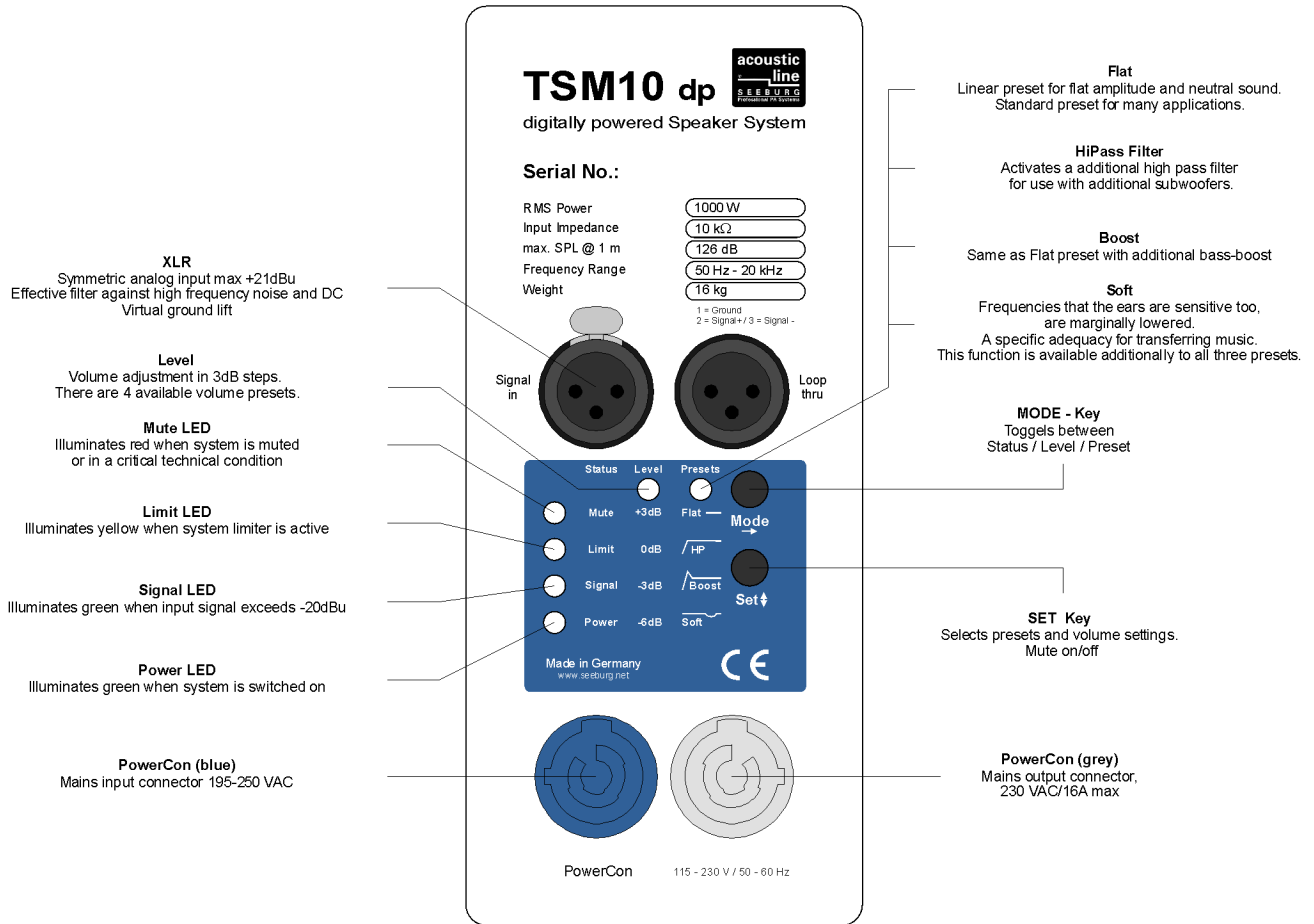

TSM10dp 90°x 60° horizontal - 2D Directivity Plot

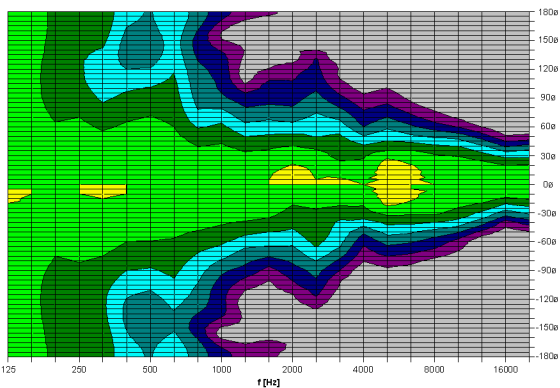

TSM10dp - Presets - Frequency response

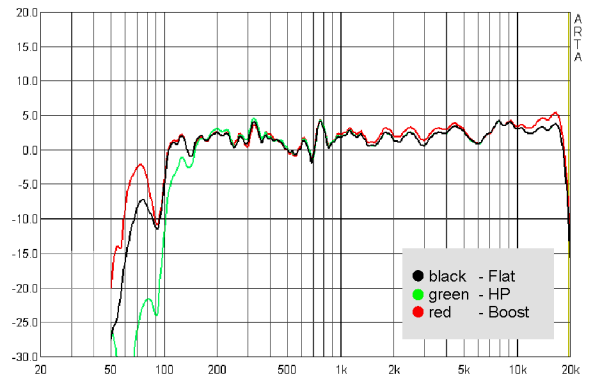

## Accessories ( additional accessories you will find in our general catalogue )

### Flying Bracket for TSM10 / TSM10dp horizontal assembly incl. screws

( per unit: 2 pcs adapters, M10 hex lock nuts, flat- and rubber washers.  
 - optional feature: 2 pcs M10 x 20 ergostyle lobe knob )

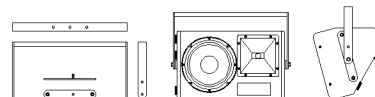

Order Number: 01220H set

### Flying Bracket for TSM10 / TSM10dp incl. screws

( per unit: 2 pcs M10 x 20 ergostyle lobe knob and rubber washers )

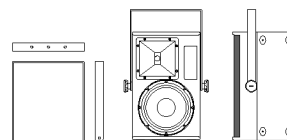

Order Number: 01220 set