

TSM Sub dp+ digitally powered Bass Extension

The TSM Sub dp+ is a high-power subwoofer loudspeaker offering extraordinary fidelity and high power with an integral Class D amplifier offering 2x 1000 watts total output power and is controlled by a 2 channel DSP. Several factory set volume settings & presets can be recalled.

Extraordinary fidelity, capability to accept very high input levels and extraordinary reliability is assured by first class design and high quality industrial electronic components, also minimizing noise.

A high effective and intelligent limiting system guarantees overload protection without limiting system capabilities.

The low weight and fanless cooling makes it suitable for applications requiring flexibility, performance as well as tonal accuracy and precise imaging.



PRODUCT SPECIFICATIONS

Speaker Components	15" Neodym
Description	High Class Subwoofer
Power	2x 1000 W EIA / 195-250 VAC
Max Line Input	+21dBu
DSP	32bit RISC
Internal Signal Path	32bit fixed-point, 64bit accumulator
	64bit IIR-coefficients
AD/DA	24bit / 48kHz
Latency	1.54ms (analog in to analog out)
All components comply with industrial temperature range	
SPL max 1m	128dB
Frequency Range	35Hz - 200Hz (Flat-Preset)
Tuning Frequency - Excursion min.	48Hz
Connectors	Neutrik XLR in/out
	Neutrik Speakon out
	Neutrik PowerCon in/out
Handles	2x 4D handle
Fittings	M20 on top
	wheelboard fittings
Weight	25,5kg
Size - height x width x depth	51,5 x 47,0 x 56,0 cm
Order Number	0972 dp+

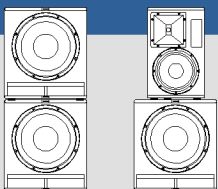
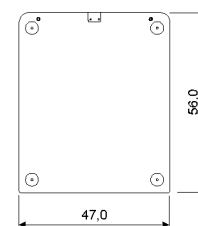
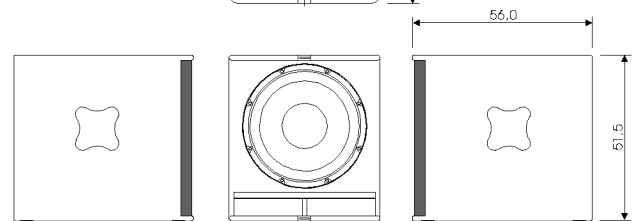
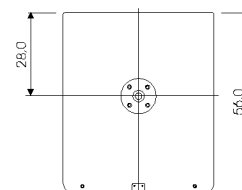
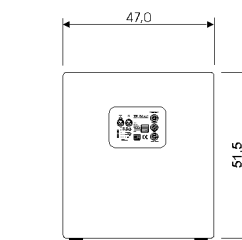

TSM Sub dp+ digitally powered Bass Extension

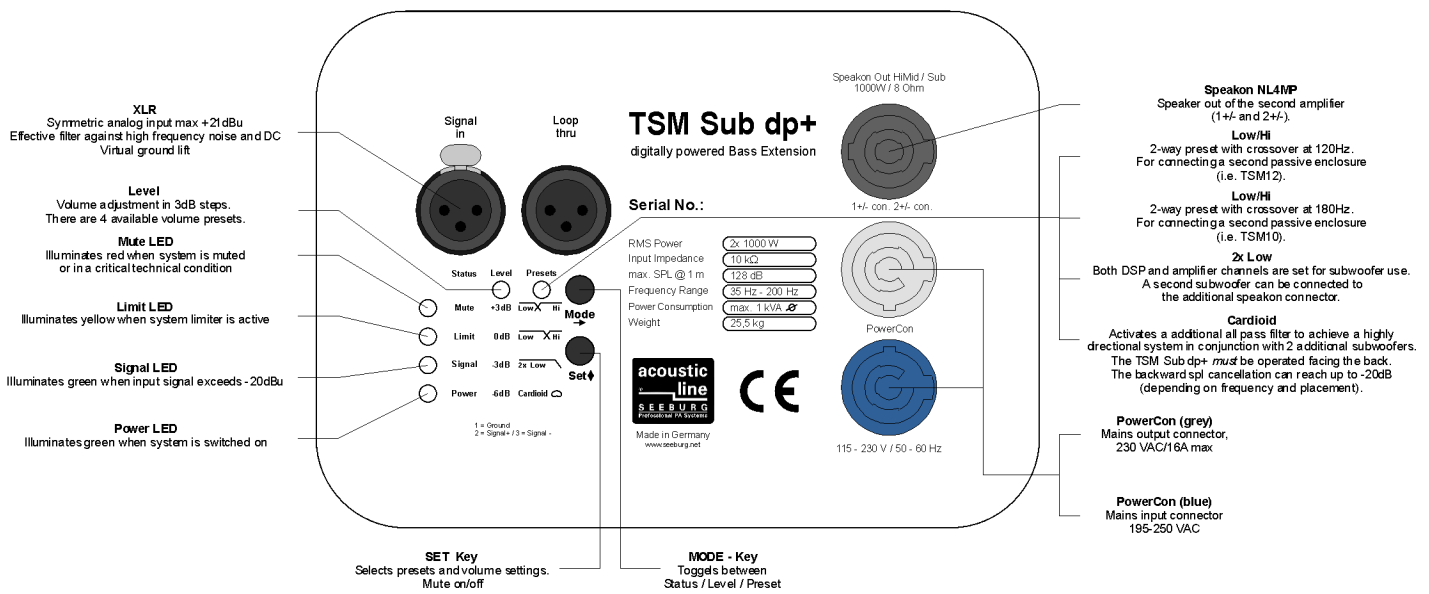

TSM Sub dp+ - Presets - Frequency response (electrical)

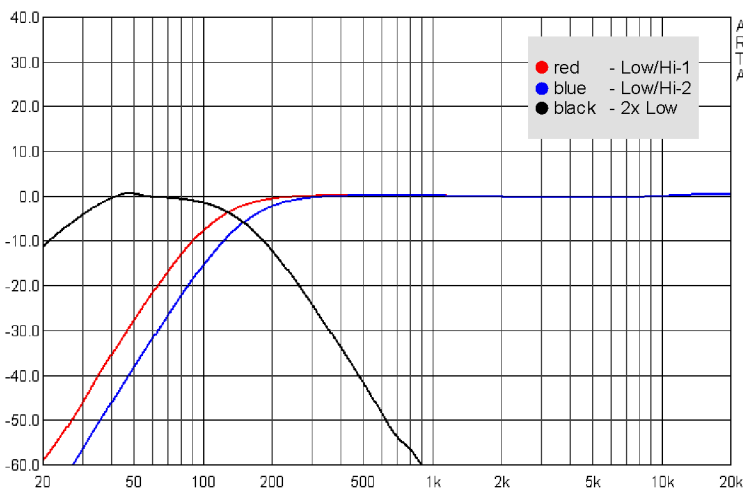

TSM Sub dp+ - Cardioid - polar diagram

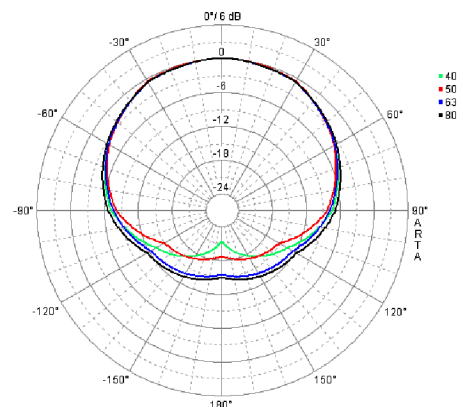

Accessories (additional accessories you will find in our general catalogue)

Wheelboard / Frontcover for TSM Sub / TSM Sub dp+

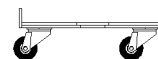
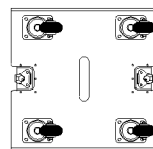

Order Number: 01265

Cover for TSM Sub / TSM Sub dp+ - padded

- Version1: use with wheelboard - Order Number: 01246

- Version2: use without wheelboard - Order Number: 01247

