

TSMini Sub dp digitally powered Bass Extension

Aktive sub extension to TSMini or TS Nano.
 Integral controller amp (Class D, 2x 500 watts) and stereo crossover for passive high-mid systems.
 The extraordinary precise transient reproduction and high peak power capability is achieved through a long excursion (32mm depth) driver with a diameter of 100mm.



PRODUCT SPECIFICATIONS

Speaker Components	12" Neodym - Longcoil
Description	Bass Extension for SAT System
Power	1000 WEIA / 195-250 VAC
Max Line Input	+21dBu
passive X-over	12 dB/oct.
All components comply with industrial temperature range	
SPL max 1m	122dB
Frequency Range	40Hz - 150Hz
Tuning Frequency - Excursion min.	48Hz
X - Overpoint	145Hz with TSMini
Connectors	2x Neutrik XLR in 2x Neutrik Speakon out Neutrik PowerCon in
Handles	2x 3D handle
Fittings	M20 on top
Weight	22,5kg
Size - height x width x depth	44,0 x 40,0 x 44,0 cm
Order Number	0992 dp

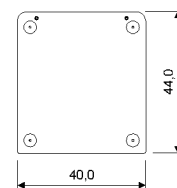
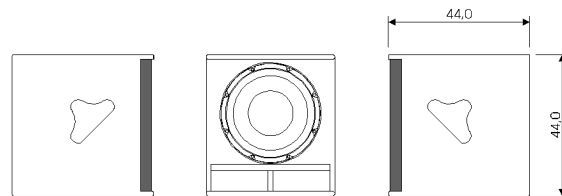
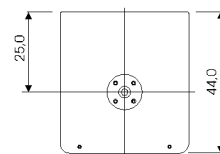
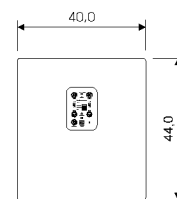

no HiMids
connected



HiMids

Serial No.:

0050

RMS Power 1000 W
 Input Impedance 10 kΩ
 max. SPL @ 1 m 122 dB

no HiMids
connected



HiMids

TSMini Sub dp

digitally powered Bass Extension

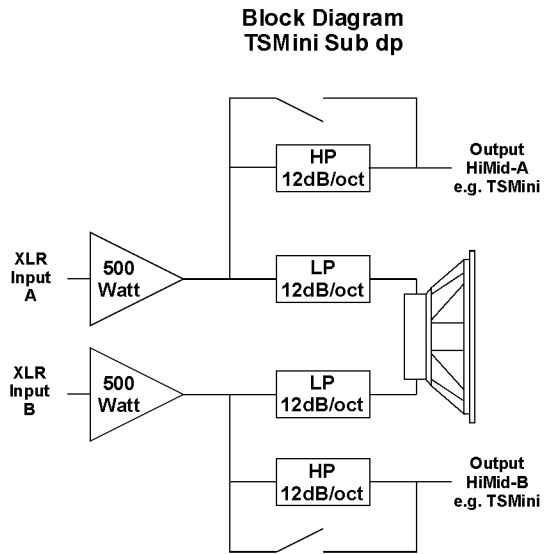
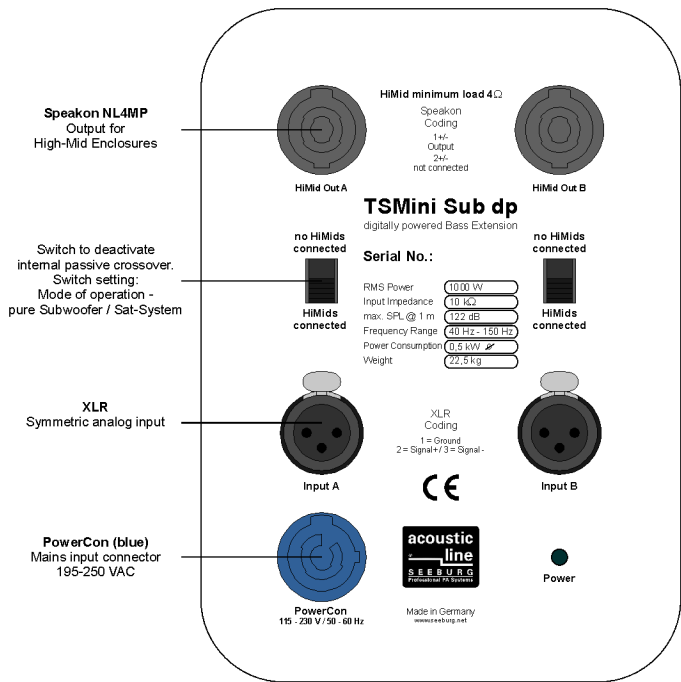

TSMini Sub dp / X-over

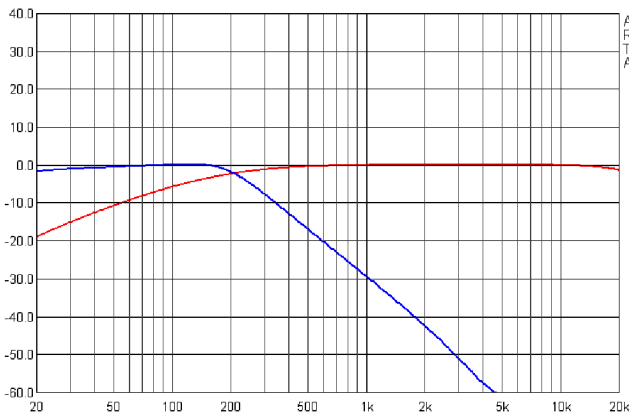

TSMini Sub dp - Frequency response

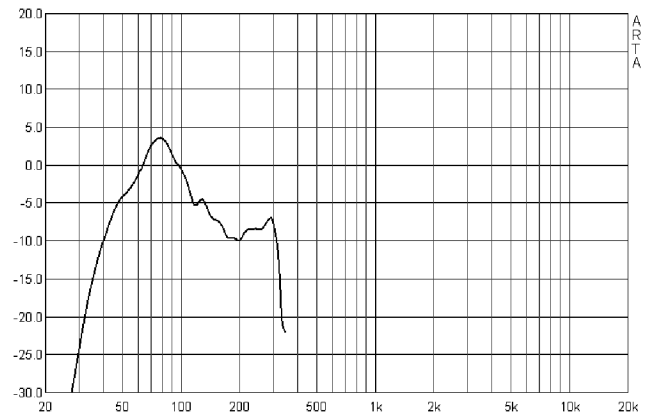

Accessories (additional accessories you will find in our general catalogue)



Cover for TSMini Sub / TSMini Sub dp - padded

Order Number: 01250



Speaker Pole, M20, 1m adjustable, K&M

Order Number: 03022